



ABN: 54 647 134 950

**PRECAST CONCRETE AUST**

[www.pcaus.com.au](http://www.pcaus.com.au)

[info@pcaus.com.au](mailto:info@pcaus.com.au)

**1300 855 402**

## TIE DOWN BLOCKS

Also known as anchoring or marquee blocks, our tie down blocks are specially designed to allow secure attachment of chains and straps to the block body. All tie down points are cast directly into the concrete at the time of pouring which ensures that they are firmly embedded into the concrete block.

We can customise all designs with additional extras including hold down bolts, reinforcing mesh, forklift pockets or painting and stencilling.



---

**sustainable precast concrete.**

## tie down blocks

Our tie down blocks are securely embedded with utility anchors which can be used to secure chains and straps but is also used to lift and handle the concrete blocks. Our standard anchors are rated to 2.5 tonnes but higher strengths can be used on request. These anchors can be used with a standard hook or clevis; no special lifting hardware is required.



## key benefits



### SUSTAINABLE

all our blocks are made in Queensland from 85% recycled construction and demolition waste.



### REUSEABLE

blocks can be moved and re-used wherever they are needed easily



### PORTABLE

all blocks come with a lifting point (cone anchor) or can be made with forklift pockets for maximum portability



### LOW MAINTENANCE

concrete does not require any special care or maintenance to continue to look good and stay strong



### CUSTOMISABLE

we can make custom blocks with all manner of accessories including ferrules, ragbolts, hold-down cages or reinforcing mesh and rebar

## applications

marquees

event tents

semi-portable structures (e.g. dongas, demountables)

light fixtures

shipping containers

# sustainable precast concrete



	SPECIFICATIONS			
SERIES	CB.0400.0400.0400	CB.0600.0600.0600	CB.0600.0600.1200	CB.0600.0600.1800
WEIGHT (KG)	160	500	1000	1500
HEIGHT (MM)	400	600	600	600
WIDTH (MM)	400	600	600	600
LENGTH (MM)	400	600	1200	1800
TIE DOWN POINTS	1	1	1	2
OPTIONAL EXTRAS	FLAT TOP (REMOVAL OF INTERLOCKING NODULE) FORKLIFT POCKETS PAINTING STENCILLING ADDITIONAL TIE DOWN POINTS			

## product range

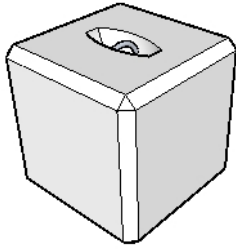

CB.0400.0400.0400.TDP

400h x 400w x 400l (0.16 tonne)

Core Features:

- 1 of 2.5 tonne utility anchor
- 20MP concrete
- 85% locally sourced recycled raw materials

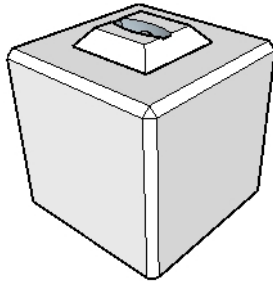

CB.0600.0600.0600.TDP

600h x 600w x 600l (0.5 tonne)

Core Features:

- 1 of 2.5 tonne utility anchor
- 20MP concrete
- 85% locally sourced recycled raw materials

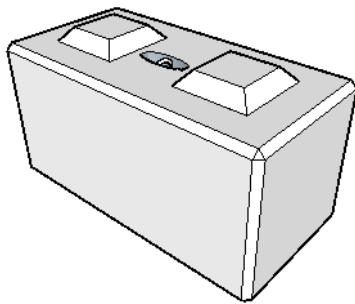

CB.0600.0600.1200.TDP

600h x 600w x 1200l (1.0 tonne)

Core Features:

- 1 of 2.5 tonne utility anchor
- 20MP concrete
- 85% locally sourced recycled raw materials

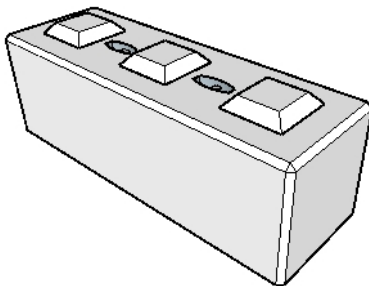

CB.0600.0600.1800.TDP

600h x 600w x 1800l (1.5 tonne)

Core Features:

- 2 of 2.5 tonne utility anchor
- 20MP concrete
- 85% locally sourced recycled raw materials

ALL PRODUCTS CAN BE FITTED WITH OPTIONAL UPGRADES:

- FORKLIFT POCKETS
- FLAT TOP (REMOVAL OF INTERLOCKING NODULE)
- PAINTING & STENCILING
- ADDITIONAL UTILITY ANCHORS / TIE DOWN POINTS

# sustainable precast concrete



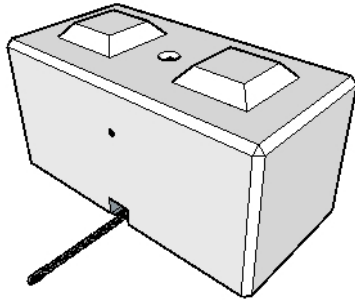

CB.0600.0600.1200.HV.M16F

600h x 600w x 1200l (1.0 tonne)

**Core Features:**

- M16 female threaded ferrule, cast into block
- N12 crossbar
- Horizontal square void on bottom (100x100mm)
- 20MP concrete
- 85% locally sourced recycled raw materials

Available in interlocking or flat top variants

This block has been especially designed to allow a chain or strap to pass underneath the block. The chain can then be secured to the cast-in female threaded ferrule which is reinforced with a cross bar.

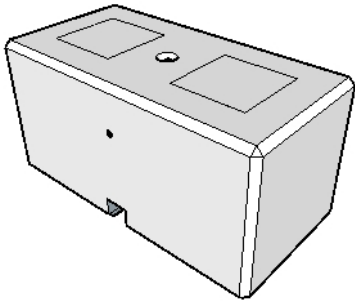



---

Precast Concrete Aust (PCA) is a privately owned Queensland company that manufactures sustainable precast concrete products from mostly recycled materials. Our products are available in a range of standard sizes and configurations of interlocking, flat-top and anchoring blocks. We also provide tailor-made custom precast products for clients requiring a unique solution to a unique problem. All of our customer service, design and manufacturing is done in-house at our manufacturing facility located in Pinkenba which has the capacity to produce greater than 500 tonnes of precast concrete per month.

We focus on producing sustainable concrete products by incorporating sustainable business practices at every step of the concrete lifecycle. We offer a whole of life product stewardship program to help clients recycle their concrete products to prevent unwanted blocks from ending up in landfill.



[info@pcaus.com.au](mailto:info@pcaus.com.au)



[www.pcaus.com.au](http://www.pcaus.com.au)



1300 855 402



18 Sandmere Road  
Pinkenba, Queensland